

LUNA 320W BALLOON LIGHT OWNER MANUAL



- EASY TO USE
- FULLY ILLUMINATED
- CONVENIENT TO CARRY
- DURABLE AND STURDY



CALIFORNIA PROPOSITION 65 WARNING

This product may contain chemicals known to the state of California to cause cancer, birth defects, or other reproductive harm.

For more information: www.P65Warnings.ca.gov

Before operating this machine, read the HELIOS Owner's Manual thoroughly. If the machine is sold, the manual should accompany it to ensure proper use and safety.



DO NOT THROW AWAY OWNER'S MANUAL.



Congratulations on Your Purchase.

Thank you for purchasing the LUNA Balloon Light. This manual contains essential instructions for assembly, operation, maintenance, and safety to ensure optimal performance and durability. Please read it carefully before use.

Important Manual Information

This manual highlights safety precautions and provides operational guidance. Look for the following safety alert symbol: . It signifies potential hazards that may lead to injury or death. Adhere strictly to all warnings and instructions.



WARNING: Using this product outside the guidelines in this manual could result in death or serious injury.



WARNING: Keep out of reach of children.



WARNING: Children can suffocate by playing inside the uninflated balloon light diffuser or its packaging. Keep all parts away from children and infants.



WARNING: This product contains small parts that may cause choking. Keep these away from children.



WARNING: Read and understand this manual completely before operating the machine.

For further assistance, contact a **SUPER EMPOWER** dealer, visit www.super-empower.com, or call +1 510-891-1056.

Note: SUPER EMPOWER reserves the right to improve its products at any time without prior notice. This manual contains the most current product information available at the time of printing, though minor discrepancies may exist.

SUPER[®] EMPOWER

Bright Mobile Energy



Access our website by
scanning our QR code

2025 by SUPER EMPOWER 1st Edition, Jan 2025
Any reprinting or unauthorized use without the written
permission of SUPER EMPOWER is expressly prohibited.
Design in U.S.A.
Model: HL10-800

*SOLTECH reserves the right to update all product data
sheets at any time. Consult SUPER EMPOWER marketing
specialists for publication updates at
hello@super-empower.com*

*Copyright©2018-2025 SOLTECH LLC,
All Rights Reserved.*

CONTENTS

| | |
|--|-----------|
| 1. SAFETY INFORMATION | 6 |
| <hr/> | |
| 1.1 Falling or Tipping Over | 6 |
| 1.2 Electrical Shock | 6 |
| 1.3 Carry Bag | 7 |
| 1.5 Fire/Explosion | 7 |
| 1.6 High Temperature | 7 |
| 1.7 Modification to Fixture | 7 |
| 2. PRODUCT DESCRIPTION | 8 |
| <hr/> | |
| 3. CONTROL FUNCTION | 9 |
| <hr/> | |
| 4. PREPARATION & OPERATION | 10 |
| <hr/> | |
| 4.1 Tripod Preparation & Operation | 10 |
| 4.2 Balloon Light Fixture Preparation | 12 |
| 4.2.1 Tripod Adapter | 12 |
| 5. MAINTENANCE, STORAGE & TRANSPORT | 13 |
| <hr/> | |
| 6. CONSUMER INFORMATION | 13 |
| <hr/> | |
| 7. WARRANTY INFORMATION | 14 |
| <hr/> | |

—1. SAFETY INFORMATION



1.1 Falling or Tipping Over

- Set up the tripod on a flat, level surface. Fully extend the legs, and securely tighten the screw knob connecting the legs to the center bracket.
- Do not use on uneven or sloped surfaces.
- Never transport or move a fully assembled LUNA Balloon Light. Always turn off, unplug, and disassemble before moving.
- Ensure the balloon light is securely fastened to the tripod by tightening all screws and knobs before use.
- Exercise caution when extending or retracting the tripod. Loosen the knobs before adjusting, and brace the fixture to prevent sudden movements.
- Do not operate in wind gusts exceeding 20 MPH. For winds over 15 MPH, anchor the tripod using stakes or sandbags.



1.2 Electrical Shock

- The LUNA Balloon Light is rated IP65 for dust and water resistance and can be used in mildly wet conditions on the tripod. Avoid operation during rain or snow.
- Always turn off and unplug the fixture before handling.
- Avoid handling the fixture with wet hands unless you have verified that the power cords are properly grounded.
- Use extension cords with a durable rubber sheath (IEC245) to withstand mechanical stresses.
- Always connect the ground lead of the plug to the grounding terminal of the power source properly.

1.3 Carry Bag



- **WARNING:** Do not operate the balloon light while it is in the carry bag. Always ensure the light is free from constraints.

1.4 Operation in Weather Conditions

- Do not operate in winds of 20 MPH or higher.
- For winds exceeding 15 MPH, secure the tripod with stakes or sandbags.
- Avoid using the balloon light in extreme weather. Contact SUPER EMPOWER customer support for guidance.

1.5 Fire/Explosion

- Operate in a well-ventilated area.
- Avoid proximity to combustible gases or flammable materials.

1.6 High Temperature

- The fixture becomes hot during operation. Do not touch LED modules while in use. Wait at least 10 minutes after powering off for the fixture to cool.

1.7 Modification to Fixture

- Do not modify or remove any parts from the fixture. Alterations may cause injury and void warranties.

— 2. PRODUCT DESCRIPTION

The LED light kit consists of:



Main Fixture

- LED Balloon Light Diffuser
- LED Balloon Light Fixture
- Tripod

Included Accessories:

- Tripod Adapter
- Safety Pin
- Remote Control
- Air Filter
- Carry Bag

—3. CONTROL FUNCTION

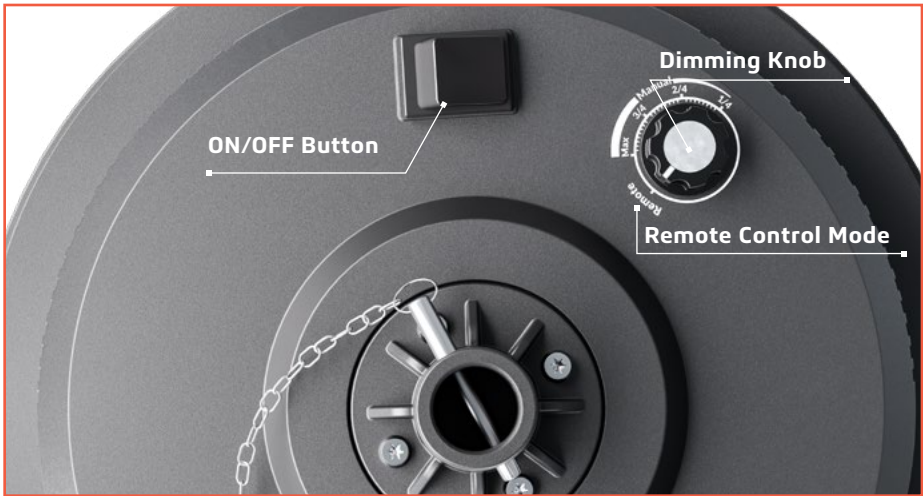

ON/OFF BUTTON

- Use the ON/OFF button to power the LUNA Balloon Light on and off.
- Ensure the diffuser is correctly mounted before use.

DIMMING KNOB

100%=320W 51,200LM

75%=200W 32,000LM

50%=150W 24,000LM

Remote Control Mode



- Turn off the fixture before unplugging. Wait at least 10 minutes before handling the hot LED module after turning off.

REMOTE CONTROL

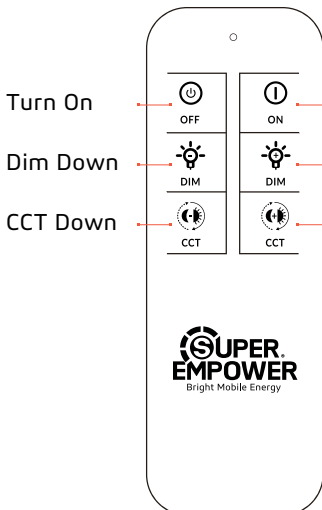

Before use the remote control, please rotate the dimming knob to **remote control mode**.

—4. PREPARATION & OPERATION

4.1 TRIPOD PREPARATION AND OPERATION

- **Select a Setup Location:**

Choose a level surface with at least 3X3 feet of space for tripod setup.

- **Unpack the Tripod:**

Remove the tripod from the carry bag and stand it upright with the legs pointing down and the Tripod Adapter on top.

- **Extend the Tripod Legs:**

Loosen the sliding knob at the base of the tripod, then pull the legs apart and slide the support bracket down until it stops. Ensure the legs are fully extended, then tighten the bottom hub knob to secure the legs.



- **Adjust the Height:**

Loosen the fixed knob, then pull up the pole to rise up the extension pole to desired height. then tighten the fixed knob. When you finished this process, always insert the safety pin to avoid instability.



Caution: Avoid pinch points when adjusting. If unsure about operating the equipment, consult an expert.

- **Retract the Tripod:**

Pull out the safety pin, then loosen the fixed knob. Loosen the fixed knob to group the extension pole into the tripod, then tighten the fixed knob.



Caution: Be aware of pinch points when retracting.

- **Close the Tripod:**

Loosen the sliding knob at the base, fold the legs inward, and tighten the sliding knob to secure.

- **Transport the Tripod:**

Ensure the tripod is retracted and all knobs are secure. Place it in the carry bag for transportation.



—4. PREPARATION & OPERATION

4.2 BALLOON LIGHT FIXTURE PREPARATION

• Unpack the Balloon Light:

Carefully remove the balloon light from its packaging without using sharp tools to avoid damage. Securely attach it to the balloon light following the instructions provided below.

01. Unfold the diffuser, and hook the four hooks inside to the top of the steel cage frame. (Hook the shorter section).
02. Fix the elastic band of the diffuser to the lamp.
Always set up the tripod on a flat surface and ensure the tripod legs are fully extended. Make sure the screw knob on the hub slide is tightened so the legs stay stable.
03. Put the tripod adaptor on the top of the tripod, then fasten the fixed knob.
04. Connect the lamp base to the telescopic tube, fasten the fixed knob, and slightly rotate the lamp to make sure the fixed knob is fastened.

! Always use a safety pin when mounting the light to the tripod adaptor.

• Safety Note:

Do not attempt to install, suspend, or mount the balloon light without consulting an expert or contacting a SUPER EMPOWER representative at www.super-empower.com/contact-us.

4.2.1 TRIPOD ADAPTER

- The Tripod Adapter enables the balloon light to be mounted on the SUPER EMPOWER 8.6 ft tripod.

• To Install:

1. Put the tripod adapter into the top of the tripod, then fasten the fixed Knob.
2. Mount the Balloon Light Fixture onto the tripod adapter, then firmly tighten the knob to secure the fixture. After that, insert the air filter at the bottom of the fixture.

! Ensure the tripod setup follows Section 4.1 to avoid injury or damage.



—5. MAINTENANCE, STORAGE & TRANSPORT



Before performing maintenance, make sure the fixture is turned OFF and unplugged from any power source.

MAINTENANCE

- We recommend cleaning the fixture after every use.
- Clean the diffuser with a soft cloth after detaching it from the fixture.
- Use compressed air to clean the fixture.
- Wipe the tripod with a damp cloth and dry thoroughly. A light soap solution may be used.

STORAGE & TRANSPORT

- Remove and fold the diffuser for storage.
- Store the fixture and tripod in their respective carry bags.
- Keep the product in a clean, dry location.

For more information, visit www.super-empower.com, or contact SUPER EMPOWER customer support.

—6. CONSUMER INFORMATION

PRODUCT: _____

MODEL NUMBER: _____

SERIAL NUMBER: _____

For detailed warranty information, please see [pages 14–15](#) of this manual.

Please hold onto your SUPER EMPOWER HELIOS balloon light purchase invite in order to claim your lifetime warranty free from defects.

For general inquiries, please visit: www.super-empower.com/contact/

Or call: [+1 510-891-1056](tel:+15108911056)

— 6. WARRANTY INFORMATION

LIMITED WARRANTY

SUPER EMPOWER® warrants any product or component manufactured by **SUPER EMPOWER®** in materials and quality for a period of **5 years** from the date of shipment, provided the conditions of installation and operation have been proper. At **SUPER EMPOWER®**'s option, any product proven to be defective within the warranty period will either be repaired or replaced. This warranty only covers items manufactured by **SUPER EMPOWER®**. It does not cover purchases where **SUPER EMPOWER®**'s warranty is specifically excluded from the purchase price. The above warranty also does not include equipment and components not manufactured by **SUPER EMPOWER®**. These items carry the guarantee of their respective manufacturers.

ELIGIBILITY—Warranty extends to the original buyer only. Proof of purchase is required.

LIGHT FIXTURES—This limited warranty applies to **SUPER EMPOWER®**'s LED light fixtures as expressly classified in the purchase order, catalog or invoice. Subject to the limitations, exclusions, and other terms outlined in this limited warranty, **SUPER EMPOWER®** Lighting Solutions warrants cataloged LED light fixtures against defects in materials and workmanship for a period of **five (5) years** from the date of shipment for only non-retail, project accounts defined as orders exceeding \$1500 by **SUPER EMPOWER®** as follows:

- **Years 1 through 5—SUPER EMPOWER®** will, at its option, replace, repair, reimburse, or credit 100% of the original purchase price of the defective light fixture, battery or battery pack, electronic components, or electronics controllers. At its option, **SUPER EMPOWER®** can attempt to repair defective luminaire samples or ship new lights to replace defective lights [given a non-negligent treatment of products].

SUPER EMPOWER® reserves the right to replace or repair defective fixtures, components, or electronics utilizing the same or functionally similar products that are new, rebuilt or reconditioned.

LED modules are warranted for a period of 5 years. An LED module failure in an LED light fixture is deemed to have occurred if 10% or more of the individual LED chips in the light fixture do not illuminate. An LED module that fails within the manufacturer's warranty period will be exchanged. **SUPER EMPOWER®** will not honor a cash reimbursement claim to cover material charges for replacement material after one year from the date of shipment. No charges for the rental of equipment, travel time, or labor will be accepted.

BATTERY—Warranties are a minimum of **five (5) years**. With full details regarding this warranty, review the Terms and Conditions below:

5-Year Battery Warranty:

- **0 to 36 months: 100% credit (user pays 0% of replacement battery price)**
- **37 to 48 months: 40% credit (user pays 60% of replacement battery price)**
- **49 to 60 months: 20% credit (user pays 80% of replacement battery price)**

Battery technology develops quickly—**SUPER EMPOWER®** can replace original batteries with equivalent or higher-capacity options as technology evolves. After 5 years from the date of shipment to the customer, customers can purchase new **SUPER EMPOWER®** batteries and have them installed to extend use outside of **SUPER EMPOWER®**'s original 5-year warranty period.

FIXTURE AND ACCESSORY PAINT FINISHES—SUPER EMPOWER® outdoor fixtures feature a baked-on polyester-powder finishing.

Outdoor Fixture Finishes: The outdoor fixture finish is warranted for **five (5) years** from the date of shipment by **SUPER EMPOWER®** against cracking, peeling, chalking, or fading.

Indoor Fixture Finishes: The indoor fixture finish is warranted for everyday indoor use for **two (2) years** from date of shipment.

Solar PV Panel Output Power—The solar panel is warranted for 20 years from the date of shipment by **SUPER EMPOWER®**.

CAUSTIC OR CORROSIVE ENVIRONMENTS—Fixtures, accessories, and their finishes may be damaged by application in caustic or corrosive environments. While many **SUPER EMPOWER®** products generally can be safely applied in such environments,

the expected useful life of products used in these environments, including the painted and Finished surfaces of such products may be reduced or impacted by the conditions in these environments. Fatigue, damage, or failure of products applied in such environments, including the painted and finished surfaces of such products, are expressly excluded from this warranty.

FIXTURE AND POLE PAINT FINISH WARRANTY CLAIMS—If during the warranty period, the finish of a fixture or pole shows signs of failure, **SUPER EMPOWER®** must be promptly notified in writing within **sixty (60) days** of such failure becoming evident together with proof of purchase; otherwise **SUPER EMPOWER®** may at its option not honor the warranty. Transportation, removal, and installation costs are not included in the replacement.

TERMS AND CONDITION OF EACH LIMITED WARRANTY—The determination of whether a product is defective and covered by its warranty shall be made by **SUPER EMPOWER®** at its sole discretion, with consideration given to the overall performance of the product compared to its specifications. **SUPER EMPOWER®** reserves the right to examine all products to determine the cause of failure or damage and usage pattern. **SUPER EMPOWER®** may require the material to be returned to **SUPER EMPOWER®** as part of the evaluation process. After contacting **SUPER EMPOWER®** and receiving a return **AUTHORIZATION NUMBER**, the user shall promptly return the product to **SUPER EMPOWER®** at the user's expense after receiving instructions on when and where to ship the product. Failure to follow this procedure shall void this warranty. The terms of each warranty apply only when the relevant product has been properly handled, stored, wired, transported, installed, operated, and maintained by all applicable product specifications, including, without limitation, installation in applications in which ambient temperatures are within the range of specified operating temperatures and operation with the electrical values provided for in the specifications. **SUPER EMPOWER®** shall have no responsibility under the terms of any warranty for any failure of any product that results from external causes, including without limitation: misapplication; acts of nature, physical damage, exposure to harsh, adverse or hazardous environments or chemicals or other substances; use of harsh or reactive chemicals or agents to clean or maintain the product; environmental conditions; vandalism; fire; power failure, improper power supply, power surges or dips and/or excessive switching; fatigue, failure or damage or similar phenomena resulting from induced vibration, harmonic oscillation or resonance associated with movement of air currents around the product; animal, pest or insect activity; fault or negligence of the purchaser of the products, any end user of the product and any third party not engaged by **SUPER EMPOWER®**; improper or unauthorized use, installation, handling, storage, alteration, maintenance or service, including failure to abide by any product classifications or certifications, or failure to comply with any applicable standards, codes or specifications. The warranty does not cover any substantial deterioration due to failure to inspect, clean or maintain the product's finish. This warranty is void if the product is not used for the purpose it was designed or if **SUPER EMPOWER®** has not authorized and approved any repairs or alterations.

The limited warranty may be transferred to subsequent purchasers of the product, provided that the product is resold in new condition and in its original packaging. In such cases, the warranty period begins from the date of shipment.

THE FOREGOING WARRANTY PROVISIONS ARE EXCLUSIVE AND ARE GIVEN AND ACCEPTED IN PLACE OF ANY AND ALL OTHER WARRANTIES, WHETHER EXPRESS OR IMPLIED, INCLUDING WITHOUT LIMITATION ANY WARRANTY AGAINST INFRINGEMENT AND ANY IMPLIED WARRANTIES OF MERCHANTABILITY OR FITNESS FOR A PARTICULAR PURPOSE.

IN NO EVENT SHALL **SUPER EMPOWER** BE LIABLE FOR INCIDENTAL, COMPENSATORY, CONSEQUENTIAL, INDIRECT, SPECIAL OR OTHER DAMAGES ARISING FROM THE PURCHASE, RESALE, USE, OR DISPOSAL OF ANY PRODUCT, WHETHER THE CLAIM ARISES UNDER TORT LAW, STRICT LIABILITY, PRINCIPLES OF EQUITY, OR CONTRACT. **SUPER EMPOWER'S** AGGREGATE LIABILITY TO A DEFECTIVE PRODUCT OR OTHERWISE SHALL, IN ANY EVENT, BE LIMITED TO THE PURCHASE PRICE OF THAT DEFECTIVE PRODUCT.

SUPER EMPOWER® WILL NOT HONOR ANY WARRANTY CLAIM WITHIN THE APPLICABLE WARRANTY PERIOD WITHOUT PRIOR WRITTEN APPROVAL AND AUTHORIZATION FROM **SUPER EMPOWER®**.

ALL **SUPER EMPOWER®** warranty inquiries should be directed to the **SUPER EMPOWER®**'s headquartered U.S. office: **success@super-empower.com**. Contact your local Territory Sales Rep or our marketing staff. The terms hereof are practical for purchases of products on or after the effective date set forth below.

CHANGES—**SUPER EMPOWER®** reserves the right to modify or change any of its products, pricing, Limited Warranty, and Terms and Conditions with prior notice.



"WE EMPOWER WATT MATTERS

2025 by SUPER EMPOWER® 1st Edition, May, 2025

Any reprinting or unauthorized use without the written
permission of SUPER EMPOWER is expressly prohibited.

Design in U.S.A.

Model: LUNA-320